

HARPER TRUCKS INC.

PGC NYLON HAND TRUCK SERIES

INSTRUCTIONS

PARTS LISTING

	QTY	PART NUMBER	DESCRIPTION
A	3	PGBLK-5	CROSSMEMBER
B	2	PGBLK-2	SIDE FRAME
D	4	HDW SC 3/8X1.5H	BOLT
E	4	HDW N MA15-15	NUT
F	1	PCSBLK	HANDLE
G	4	HDW SC 1/4X2 PH	BOLT
H	4	HDW N 82-15	NUT

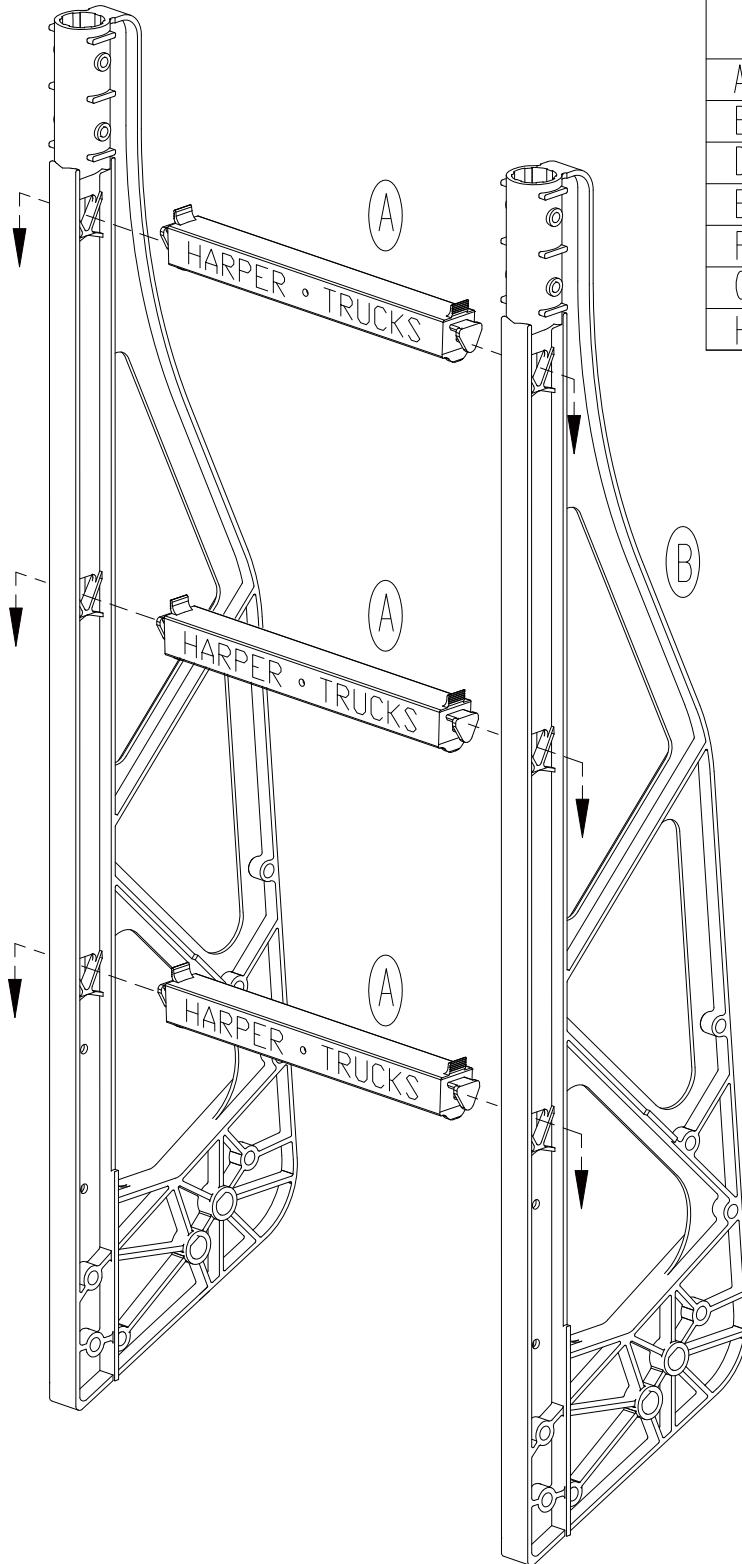

FRAME ASSEMBLY

1. INSERT CROSSMEMBERS (A), WITH NAME FORWARD, INTO THE SIDEFRAE (B). TAP DOWNWARD LIGHTLY TO SECURE TABS.

HANDLE ASSEMBLY

1. INSERT THE HANDLE (F) INTO THE SIDEFRAE (B) SOCKET AND SECURE WITH FASTENERS (G&H).

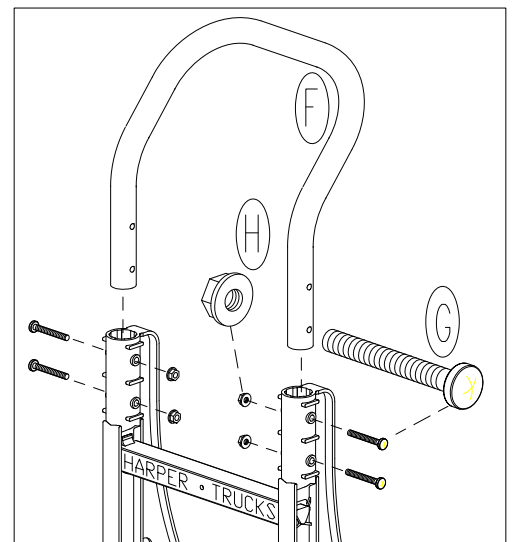

PARTS LISTING

	QTY	PART NUMBER	DESCRIPTION
I	1	PBSABLK-1	BASE PLATE
L	1	AX N225	AXLE
M	2	WH K16	WHEEL
N	8	HDW BU #2	WASHER
P	4	HDW P 106-12	COTTER PIN

BASE/AXLE ASSEMBLY

1. FASTEN THE BASE PLATE (I) TO THE FRAME WITH 4 BOLTS (D) AND NUTS (E).
2. SLIDE AXLE (L) THROUGH SIDEFRAME (B) AXLE HOLE AS SHOWN. INSERT 2 WASHERS (N) ON THE AXLE BETWEEN THE FRAMES.
3. INSTALL 2 COTTER PINS (P) IN THE AXLE BETWEEN THE SIDEFRAMES WITH THE WASHER BETWEEN THE COTTER PIN AND SIDEFRAME.
4. ASSEMBLE THE WHEELS ONTO THE AXLE WITH 2 WASHERS (N) ON THE INSIDE AND 1 WASHER (N) ON THE OUTSIDE OF THE WHEEL. SECURE WITH A COTTER PIN (P) THROUGH EACH END OF THE AXLE (L).

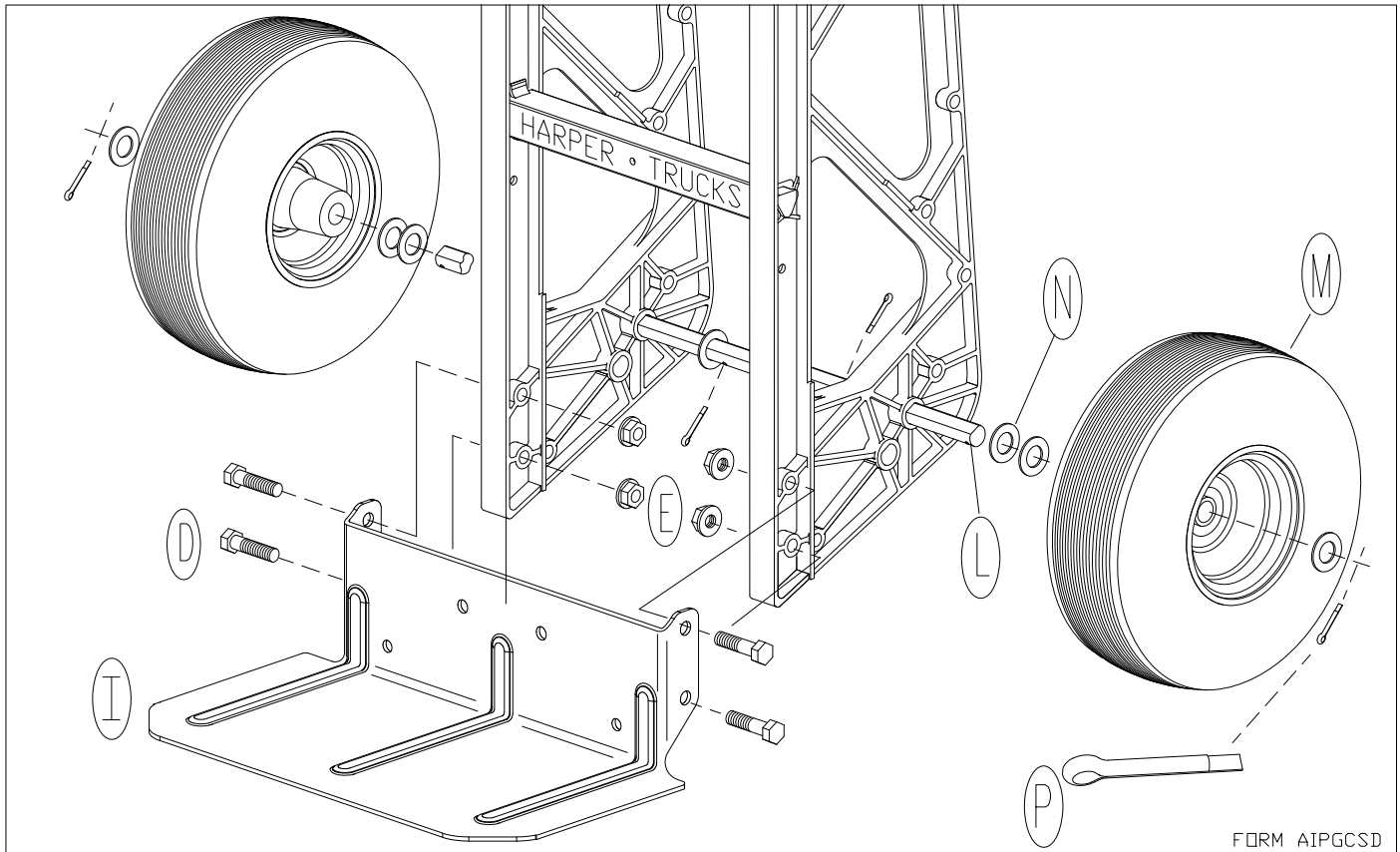

PROUDLY MADE IN WICHITA, KANSAS
 FOR ASSISTANCE CALL 1-800-835-4099
 OR VISIT WWW.HARPERTRUCKS.COM